

**GOVERNMENT OF INDIA  
MINISTRY OF RAILWAYS  
RESEARCH, DESIGNS & STANDARDS ORGANISATION  
MANAK NAGAR, LUCKNOW-226011**

No. EL/3.2.19

Dated : 3.12.99

**Chief Electrical Loco Engineers**

- Central Railway, Mumbai CST – 400001
- Eastern Railway, Fairlie Place, Calcutta – 700001
- East Central Railway, Chandrashekharpur, Bhubaneswar – 751001
- Northern Railway, Baroda House, New Delhi – 110001
- North Central Railway, Hasting Road, Allahabad – 211001
- Southern Railway, Park Town, Chennai – 600003
- South Central Railway, Rail Nilayam, Secunderabad – 500371
- South Eastern Railway, Garden Reach, Calcutta – 700043
- South Western Railway, Bangalore – 560046
- Western Railway, Church Gate, Mumbai – 400020
- West Central Railway, Jabalpur
- New Zone Railway, Bilaspur
- Chittaranjan Locomotive Works, Chittaranjan – 713331

**MODIFICATION SHEET NO. ELRS/MS/0273, REV 'O' - 99**

**1.0 Title :**

Provision of Safety Clamp for C2W Relay Valve to prevent its 'Supply Valve Assembly' from falling

- 2.0 In C2W relay valve, the supply valve assembly, WABCO Part No. 554995 is held in position with the help of a retaining ring. In case of air leakage from C2W relay valve due to its mal-functioning, the practice amongst the operating/maintenance staff existing is to tap the C2W relay valve body. It has been experienced by the sheds that due to tapping of C2W relay valve supply valve assembly ( WABCO Part No. 554995 ) falls down if retaining ring is not fitted properly or if it has lost its properties, due to aging, resulting in the failure of C2W relay valve and hence the locomotive. To overcome the above problem, a safety clamp is to be provided on C2W relay valve which acts as an additional support to hold the supply valve assembly in position in addition to retaining ring.

**3.0 Work to be Carried Out :**

The safety clamp for supply valve assembly is to be fabricated as per RDSO Drg. No. SKEL-4544 and is to be fitted on C2W relay valve with the help of existing assembly bolts. Preference is to be given to additional C2W relay valves.

**4.0 Application to the Class of Locomotive :**

All Electric Locomotives.

**5.0 Material Required :**

M.S. flat of required size as per details shown in RDSO's Drg. No. SKEL-4544 Alt. 'O'.

**6.0 Material Rendered Surplus :**

None.

**7.0 Reference :**

Decision taken in co-ordination meeting held with M/s. SIL and M/s. SAB WABCO at Electric Loco Shed, Ghaziabad on 20.11.99. (Item No. 8 of the minutes of above co-ordination meeting)

**8.0 Modification Drawing :**

RDSO's Drg. No. SKEL – 4544, Alt. 'O'.

**9.0 Agency for Implementation :**

1. All Electric Loco Sheds.
2. POH Workshops.
3. CLW in all newly manufactured locomotives.
4. M/s. SAB-WABCO and M/s. SIL in all their new supply of C2W relay valves.

**10.0 Distribution :**

As per mailing list.

Encl : One No. RDSO Drg.  
No. SKEL-4544, Alt. 'O'



**(O.H. Pande)**  
for Director General/Elect.

To,

---

---

---

---

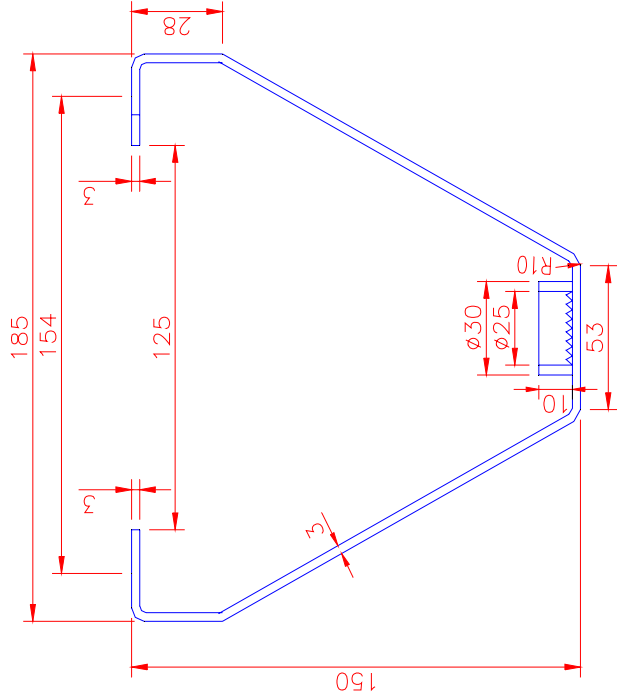

PROPOSED SAFETY CLAMP FOR SUPPLY  
VALVE OF C2W RELAY VALVE

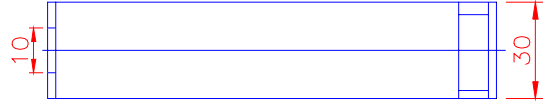

VIEW OF C2W RELAY VALVE WITH  
PROPOSED SAFETY CLAMP

NOTE:-

1. ALL DIMENSION ARE IN mm
2. CLAMP TO BE PAINTED WITH SMOKE GREY ENAMILLED PAINT.

DT: 29.11.99  
D: -  
C: -  
REV: EL.3.2.19

1	REF NO.	SAFETY CLAMP	2	MS	IS 2062 1992
	PART NO.	DESCRIPTION		NO./LOCO	MATL. SPEC.
REF:- ELRS/MS/0273 Rev. 'O' -99		SCALE: NTS	APPROVED BY (FOR DG)		
SAFETY CLAMP FOR C2W RELAY VALVE			FIRST ISSUED NOV. 99		
RDSO ELEC DTE			SUPERSEDES		
STATUS			SUPERSEDED BY		
-	-	-	-	-	-
ALT.	REF NO.	DESCRIPTION	APPROVED BY	DATE	
SAFETY CLAMP FOR C2W RELAY VALVE			SKEL-4544, ALT'O'		